

The finest wall hanging for your home

Mistletoe Wreath

Materials

- Fabric (woven)
- Vliesofix/Bondaweb (item no. 9299)
- Metal ring, 13, 17 or 30 cm
- Ribbon
- Bells
- Sewing thread, sewing needle, scissors
- Textile adhesive
- Marker pen or chalk pencil

By the way...! you can use this beautiful wreath year after year!



The number of leaves and length of the strips depend on the size of the metal ring:

- Ø 13 cm: 18 leaves + 1 strip 1.5 cm x about 30 cm.
 Ø 17 cm: 25 leaves + 2 strips, each 1.5 cm x about 25 cm.
 Ø 30 cm: 36 leaves + 2 strips, each 1.5 cm x about 55 cm.

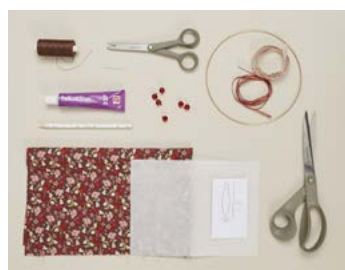

1. Make sure you have everything you need. Choose which size of metal ring you wish to use.



2. Cut 2 pieces of fabric and a piece of Vliesofix, each about 20 x 30 cm. Iron Vliesofix adhesive side down onto one piece of fabric.



3. When cool, remove the paper. Iron the second piece of fabric onto the Vliesofix.



4. Cut out the template.



5. Draw around the template on the fabric. Cut out. The Vliesofix stiffens the leaves.



6. Cut a strip or strips, and wrap tightly around the ring. Use textile glue to secure the ends. Do not cover the whole ring.

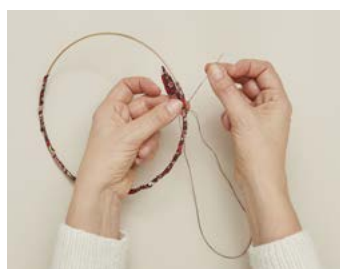

7. Fold the leaves at the bottom. Sew them tightly around the ring, starting at the fabric edge. Sew on the next leaf slightly staggered.



8. Sew bells or other ornaments onto the wall hanging. What and how many is entirely up to you. Attach ribbon for hanging.